

SL4 Series LP-A

H-Profile LP LED, Recessed Lens

Page 1 of 2

Features:

- Slim 3" Aperture.
- Crisp clean lines of light to create personalized lighting designs.
- Low brightness LEDs spread over a large area, combined with an optimized optical system, provides exceptional lighting uniformity and visual comfort.
- No pixilation or direct view of LEDs.
- Optimized system provides the desired lumen output with low operating power consumption.
- Lightweight construction.
- Chicago Plenum available.
- Precision snap-in frosted acrylic lens features flat, even surface that sits flush with housing, and includes diffusion properties to eliminate LED image.
- Driver and LED boards accessible from below for easy maintenance.
- Suitable for damp locations.
- Suitable for row mounting.
- Integrated thermal management system conducts heat away from LEDs and transfers it to the surrounding environment.

Accessories:

Dimming: reverse phase, 0-10V and DALI

Controls: Additional energy savings with Actilume 1-10V Lighting Control System and LuxSense integrated sensors.

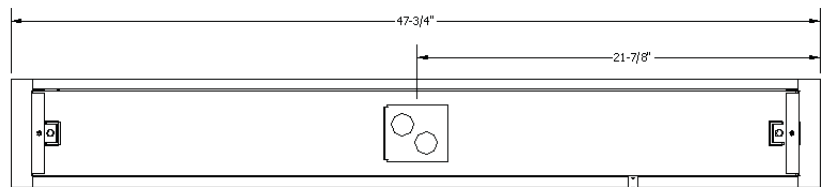
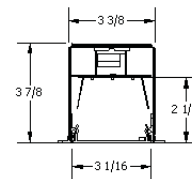

Ordering Information

Explanation of Catalogue Number: SL4GWS18A40ULAG

SL	4	G	W	B	X	18A	40	U	LAG
FAMILY	LUMINAIRE LENGTH	CEILING TYPE	FINISH	OPTIC	WIRING	LED PACKAGE	CCT	VOLTAGE	DRIVER TYPE
SL: H-Profile	4 = 48" Nominal	G = Exposed T T = Exposed slot T F = Recessed Flanged (Drywall) L = Recessed Flangeless	W = White	B = Flat frosted acrylic lens	X = N/A	18A = 1,800 lumens nominal	40 = 4000K	U = 120/277V 3 = 347V	LAG = LED Driver

Job Information Type:

Job Name:

Cat. No:

Notes:

PHILIPS
LIGHTOLIER®

SL4 Series LP-A

H-Profile LP LED, Recessed Lens

Page 2 of 2

CANDLE POWER CURVE

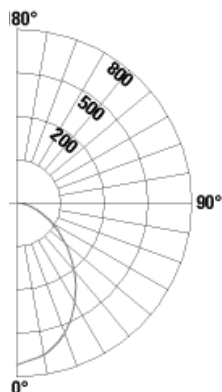

Report No: C11061
 Catalogue No: SL4GWBS18A40ULAG
 Lumen Output: 1728
 Input Watts: 25
 Efficacy: 69.1 Lm/W
 CRI: 84
 CCT: 4000K
 Candela at Nadir: 771cd

CANDLEPOWER

ZONE DEG	ALONG	22.5	45	67.5	ACROSS
0	771	771	771	771	771
5	763	772	775	768	750
10	748	757	759	751	732
15	724	732	730	717	699
20	690	696	689	673	657
25	647	651	642	623	604
30	598	601	587	564	544
35	542	544	527	501	483
40	483	482	465	437	420
45	421	420	401	372	356
50	359	357	339	311	297
55	299	296	279	253	241
60	241	240	224	202	192
65	188	186	173	154	146
70	140	138	127	112	107
75	98	96	86	76	72
80	60	58	51	45	42
85	28	25	21	18	18
90	0	0	0	0	0

COEFFICIENTS OF UTILIZATION

ZONAL CAVITY METHOD * EFFECTIVE FLOOR CAVITY REFLECTANCE = .20

80					70					50				
Wall Reflectance														
	70	50	30	10	70	50	30	10	50	30	10			
Room Cavity Ratio	0	1.19	1.19	1.19	1.19	1.16	1.16	1.16	1.16	1.11	1.11	1.11		
	1	1.10	1.06	1.03	.99	1.08	1.04	1.01	.98	1.00	.97	.95		
	2	1.02	.95	.89	.84	1.00	.93	.88	.83	.90	.85	.81		
	3	.94	.85	.78	.72	.92	.83	.77	.72	.81	.75	.71		
	4	.87	.77	.69	.63	.85	.76	.69	.63	.73	.67	.62		
	5	.81	.70	.61	.55	.79	.68	.61	.55	.66	.60	.55		
	6	.75	.63	.55	.49	.73	.62	.54	.49	.60	.53	.48		
	7	.69	.57	.49	.43	.68	.56	.48	.43	.54	.47	.43		
	8	.65	.52	.44	.38	.63	.51	.44	.38	.50	.43	.38		
	9	.60	.47	.40	.34	.59	.47	.39	.34	.46	.39	.34		
10	.56	.43	.36	.31	.55	.43	.36	.31	.42	.35	.31			

DETERMINED IN ACCORDANCE WITH CURRENT IES PUBLISHED PROCEDURES LM-79
 LUMINAIRE INPUT WATTS = 25

DISTRUBUTION

ZONE	LUMENS	%LUMINAIRE
0-30	568	32.87
0-40	893	51.67
0-60	1443	83.50
0-90	1728	100.00
40-90	835	48.33
60-90	285	16.50
90-180	0	0.00
0-180	1728	100.00

Specifications:

Materials: Chassis parts are die-formed code gauge cold rolled steel.

Lens: Frosted acrylic lens with flat even surface.

Finish: Cavity - white baked polyester enamel, minimum 85% reflectance, phosphate undercoating

Chassis exterior - white baked polyester enamel

System Life: Long life LED provides 50,000 hours at L₇₀.

Labels: cCSAus listed.



© 2011 Philips Canlyte
 All rights reserved.

525 Education Road, Cornwall, Ontario, K6H 6C7
 Phone 613-938-6221 • Fax 613-938-0961
 Quebec Division
 3015 Louis-Amos, Lachine, Quebec, H8T 1C4
 Phone 514-636-0670 • Fax 514-636-0460
 www.canlyte.com

Job Information Type:

Consult factory for additional configurations.
 Specifications are subject to change without notice.